



# MŠ Žižkova(1:700), 1/2







## Na Kopci - ulice(1:700) - Klad listů (1:4462)

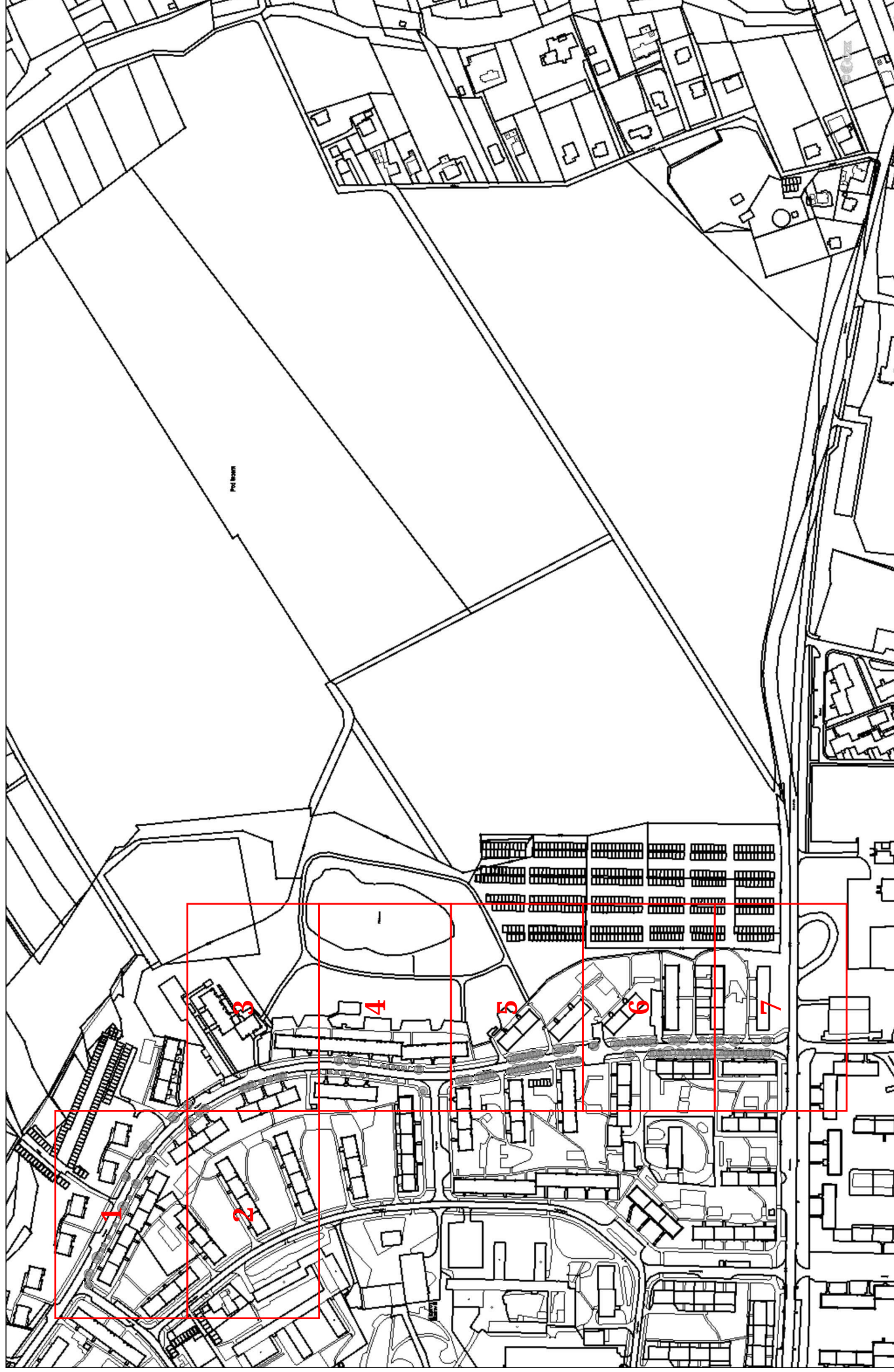







# Na Kopci - ulice(1:700), 3/7



# Na Kopci - ulice(1:700), 4/7

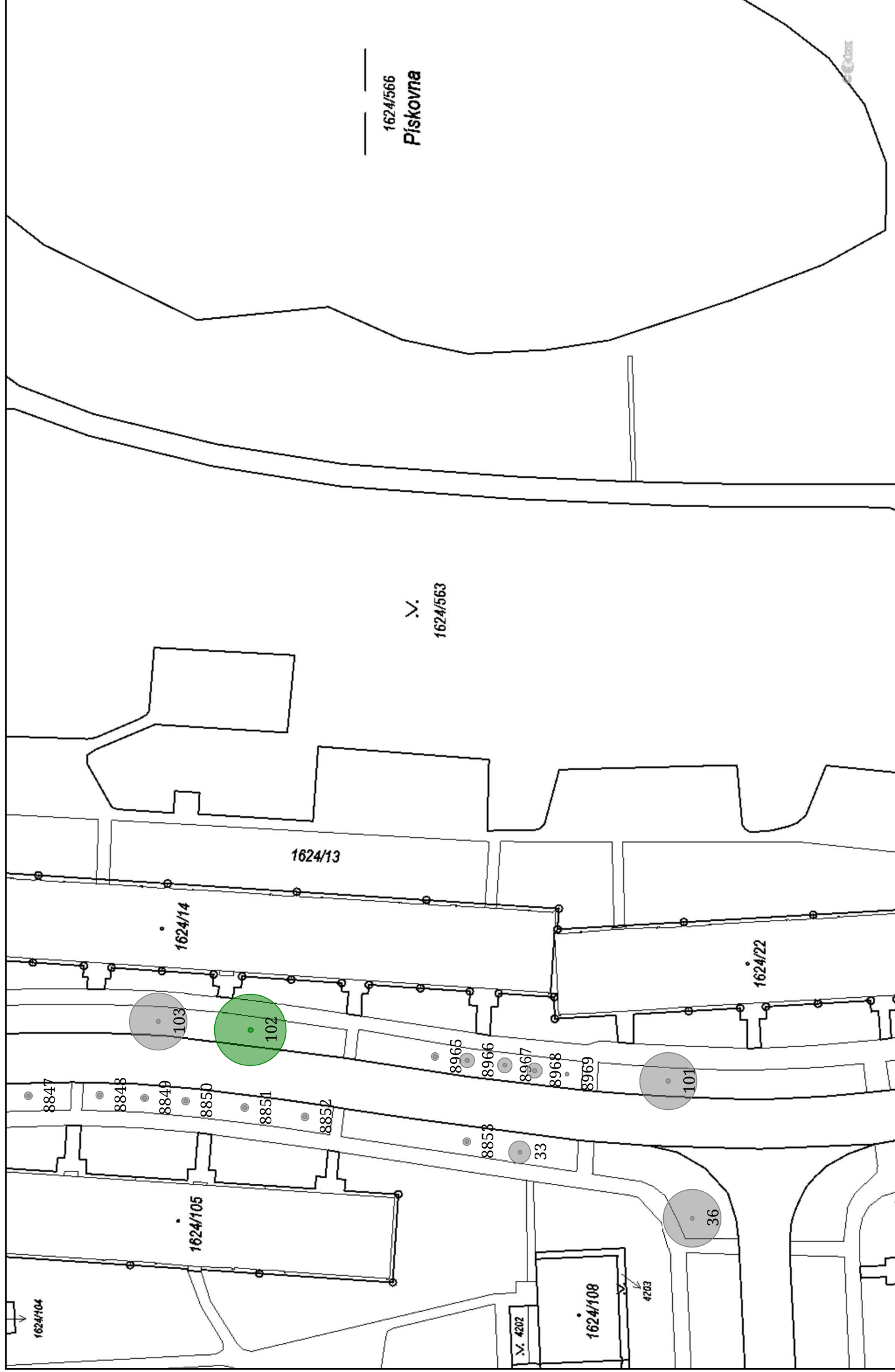



# Na Kopci - ulice(1:700), 5/7

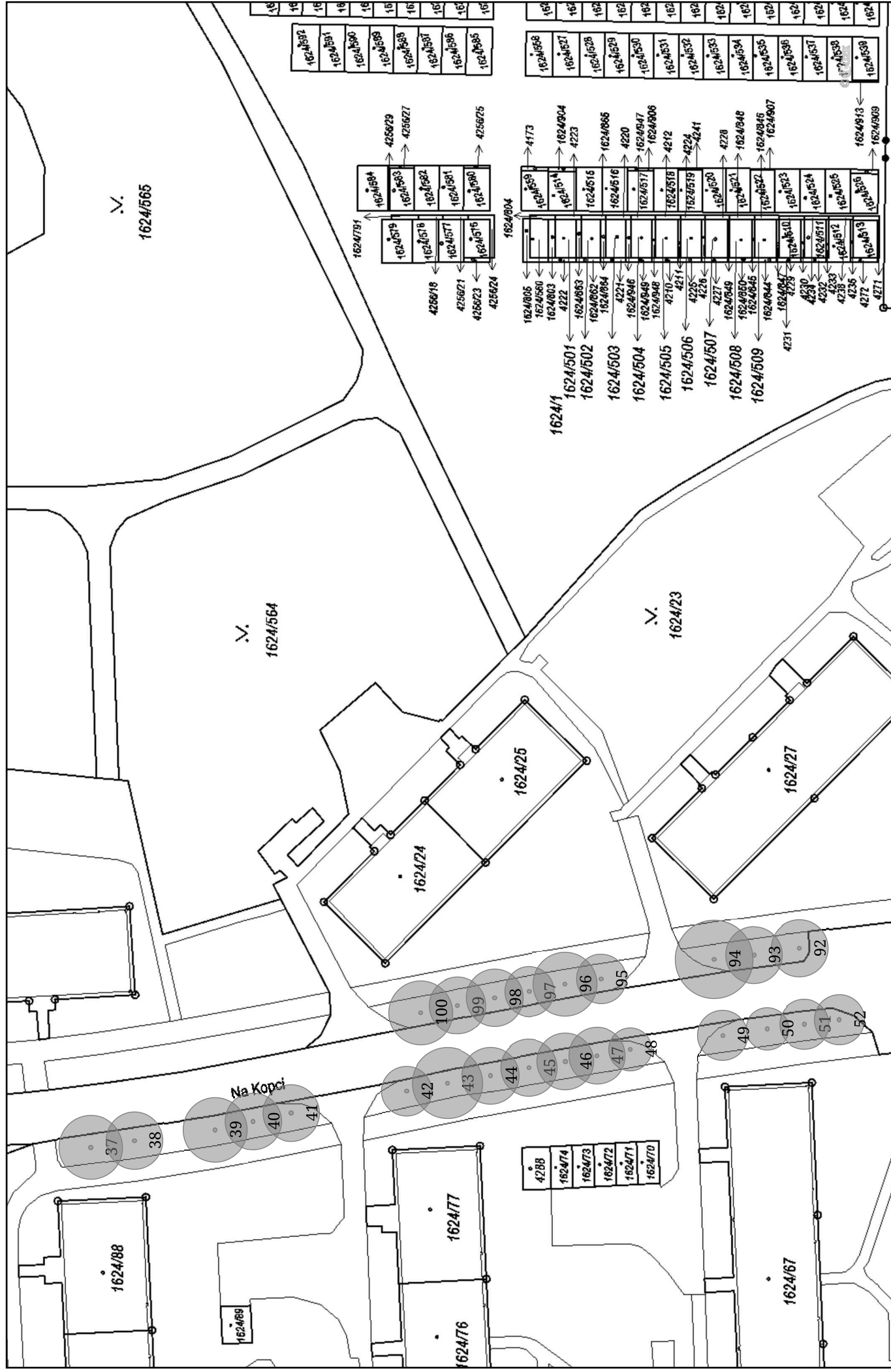



# Na Kopci - ulice(1:700), 7/7

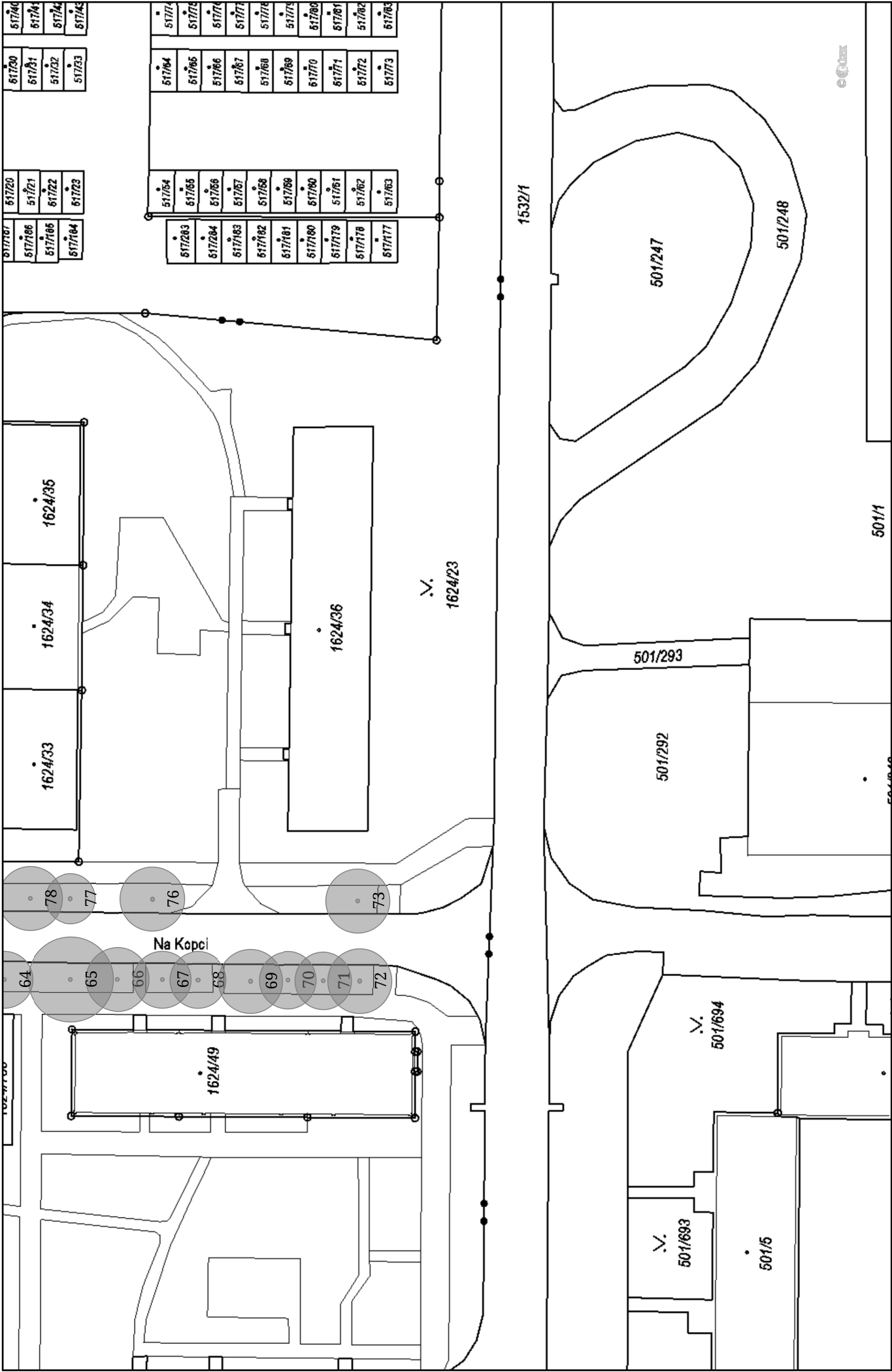



## Na Kopci(1:700) - Klad listů (1:5206)

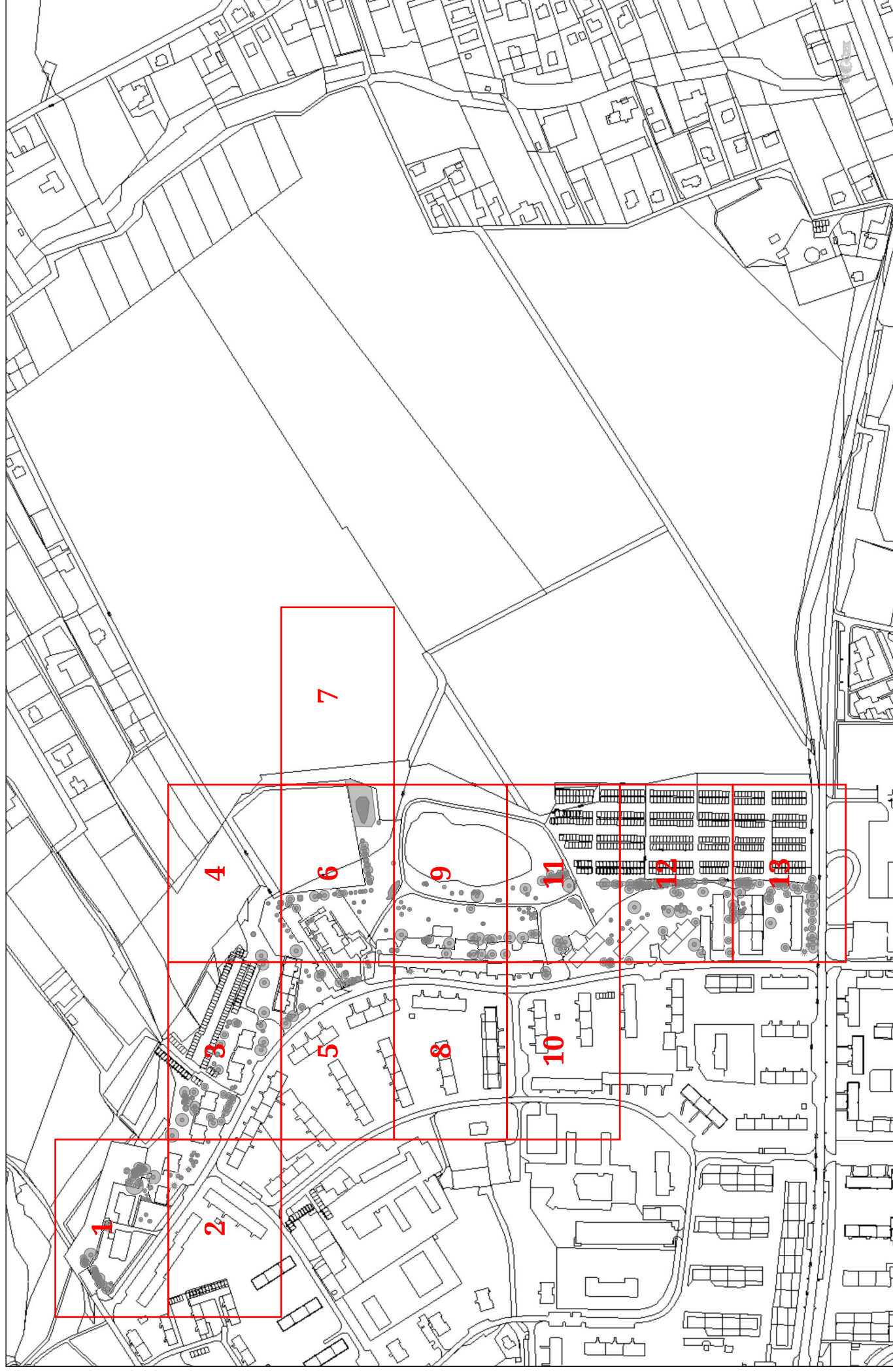



# Na Kopci(1:700), 2/13







# Na Kopci(1:700), 4/13

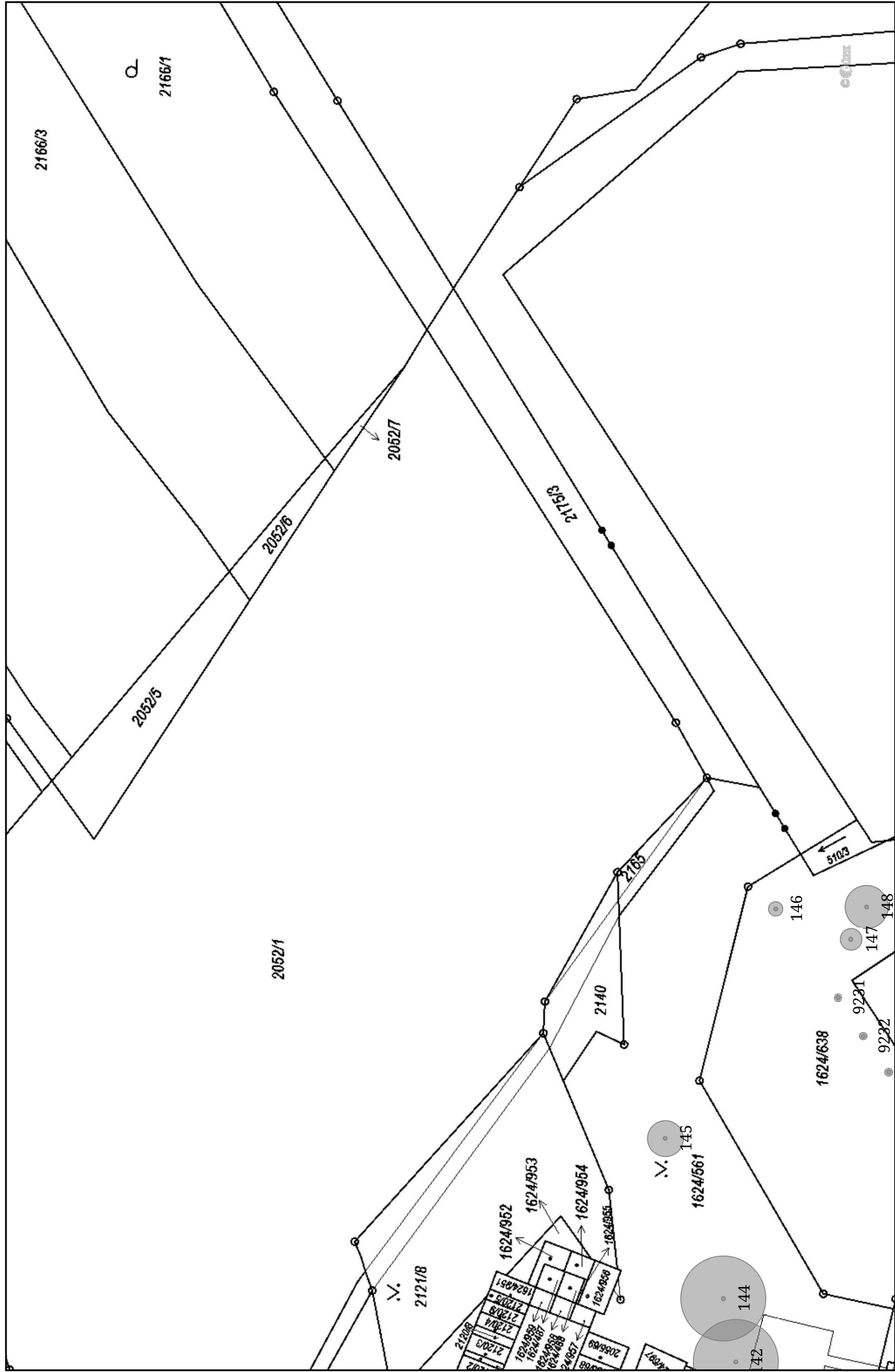

# Na Kopci(1:700), 5/13



[illegible]



# Na Kopci(1:700), 7/13

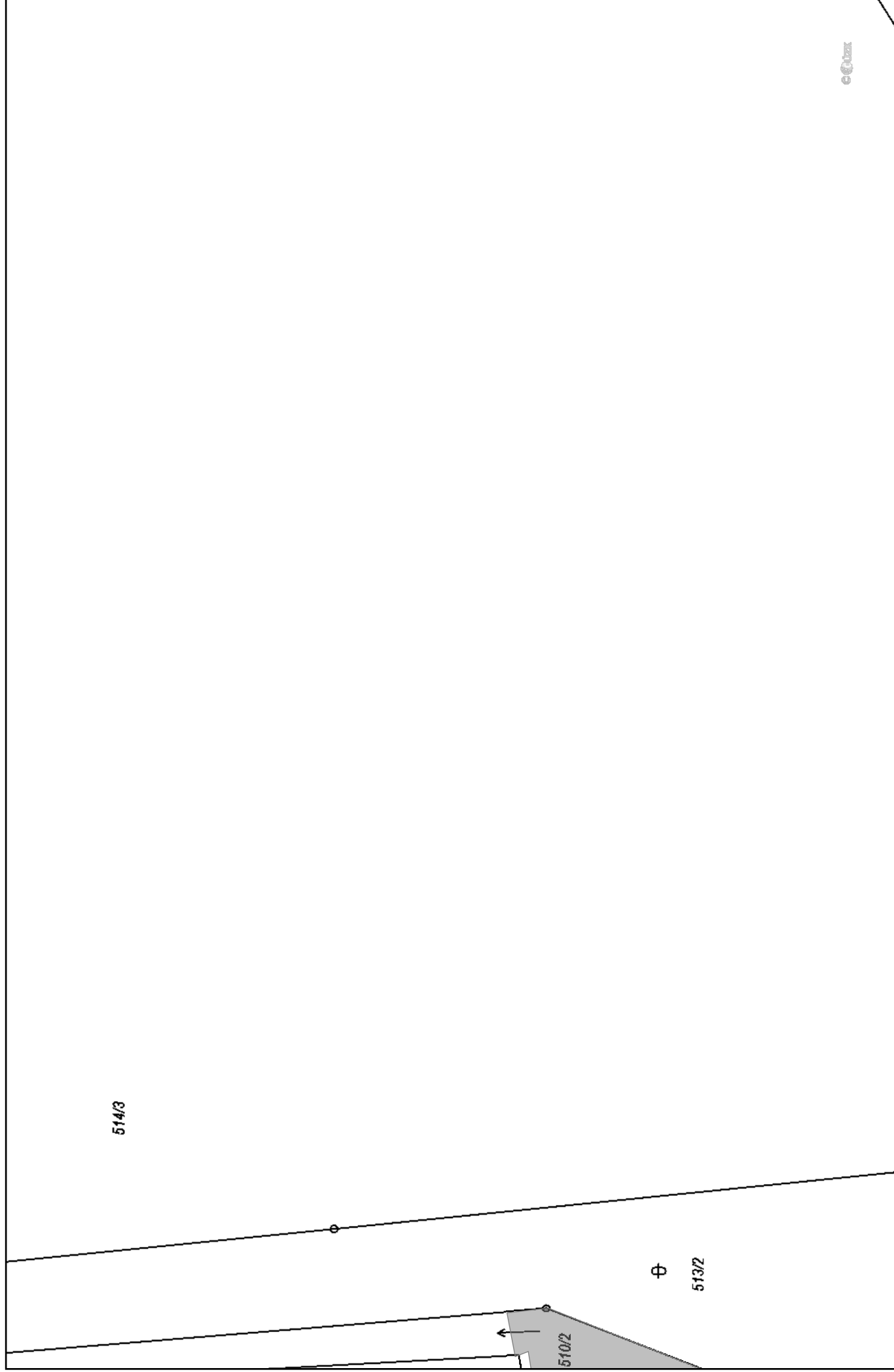



The map displays a rural landscape with various land parcels and buildings. Key features include:

- Parcel Identifiers:** Numerous numbers are scattered across the map, such as 8978, 9220, 8977, 1624/567, 188, 8959, 8961, 189, 8960, 9225, 303, 301, 299, 8975, 295, 294, 1624/13, 293, 292, 289, 287, 286, 285, 283, 282, 9212, 81253, 279, 278, 9226, 200, 9224, 193, 8964, 190, 191, 194, 195, 196, 199, 198, 203, 204, 8965, 1624/563, 1624/566, 1624/762, 8978, 9220, 8977, 188, 8959, 8961, 189, 8960, 9225, 303, 301, 299, 8975, 295, 294, 1624/13, 293, 292, 289, 287, 286, 285, 283, 282, 9212, 81253, 279, 278, 9226, 200, 9224, 193, 8964, 190, 191, 194, 195, 196, 199, 198, 203, 204, 8965, 1624/563, 1624/566, 1624/762.
- Buildings:** Several rectangular outlines represent buildings, including a large one in the center-left and smaller ones in the bottom-left and bottom-right.
- Vegetation:** Shaded green areas represent trees or shrubs, with some specific trees marked by star-like symbols.
- Water Features:** A small body of water is labeled 'V.' (water) in the top-right corner.
- Other Labels:** The text 'Pískovna' (sand pit) is visible in the center-right area.

# Na Kopci(1:700), 10/13

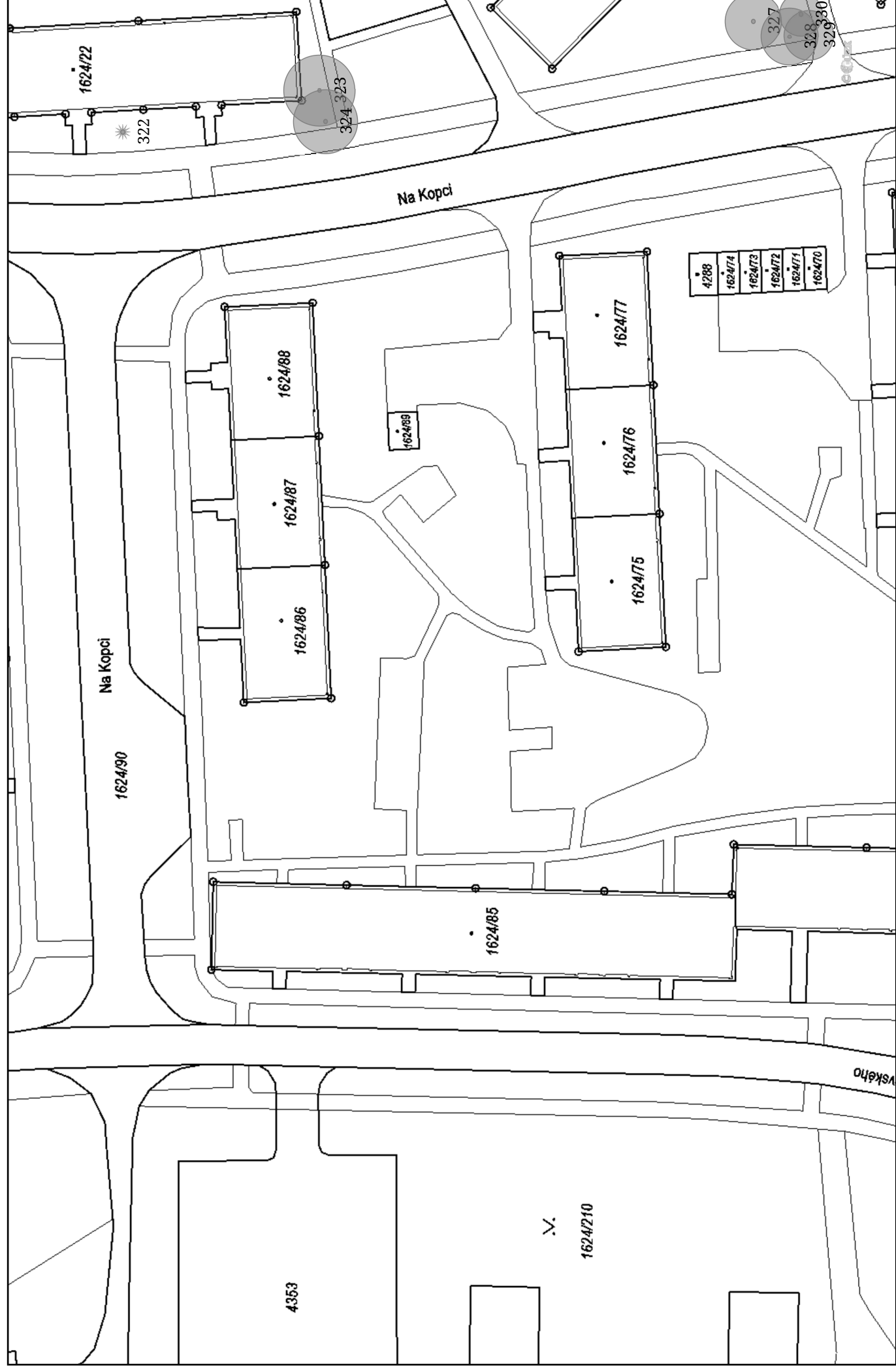







# Na Kopci(1:700), 13/13

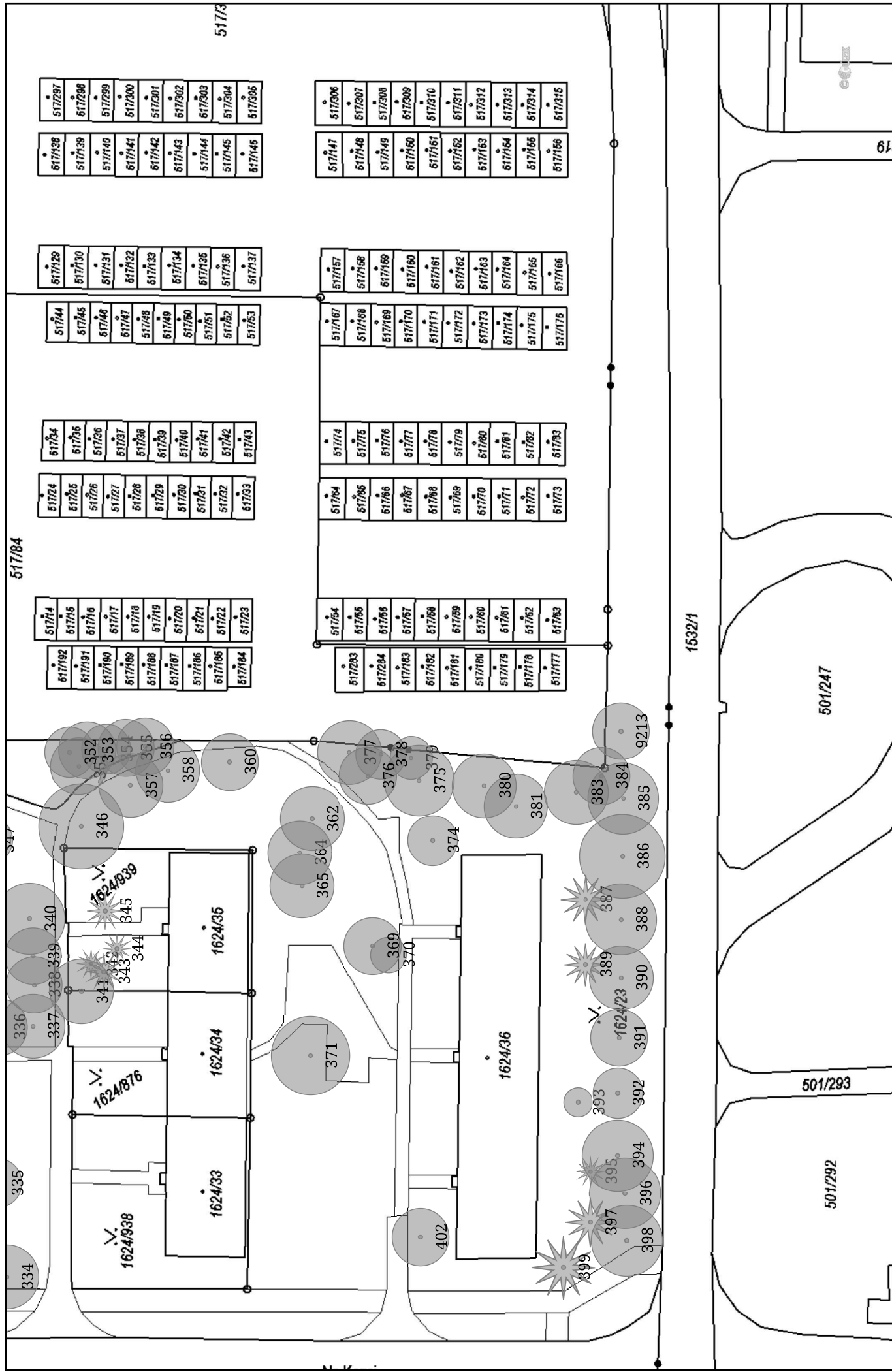



## Na Vyhlídce - okolo ZŠ(1:700) - Klad listů (1:2231)

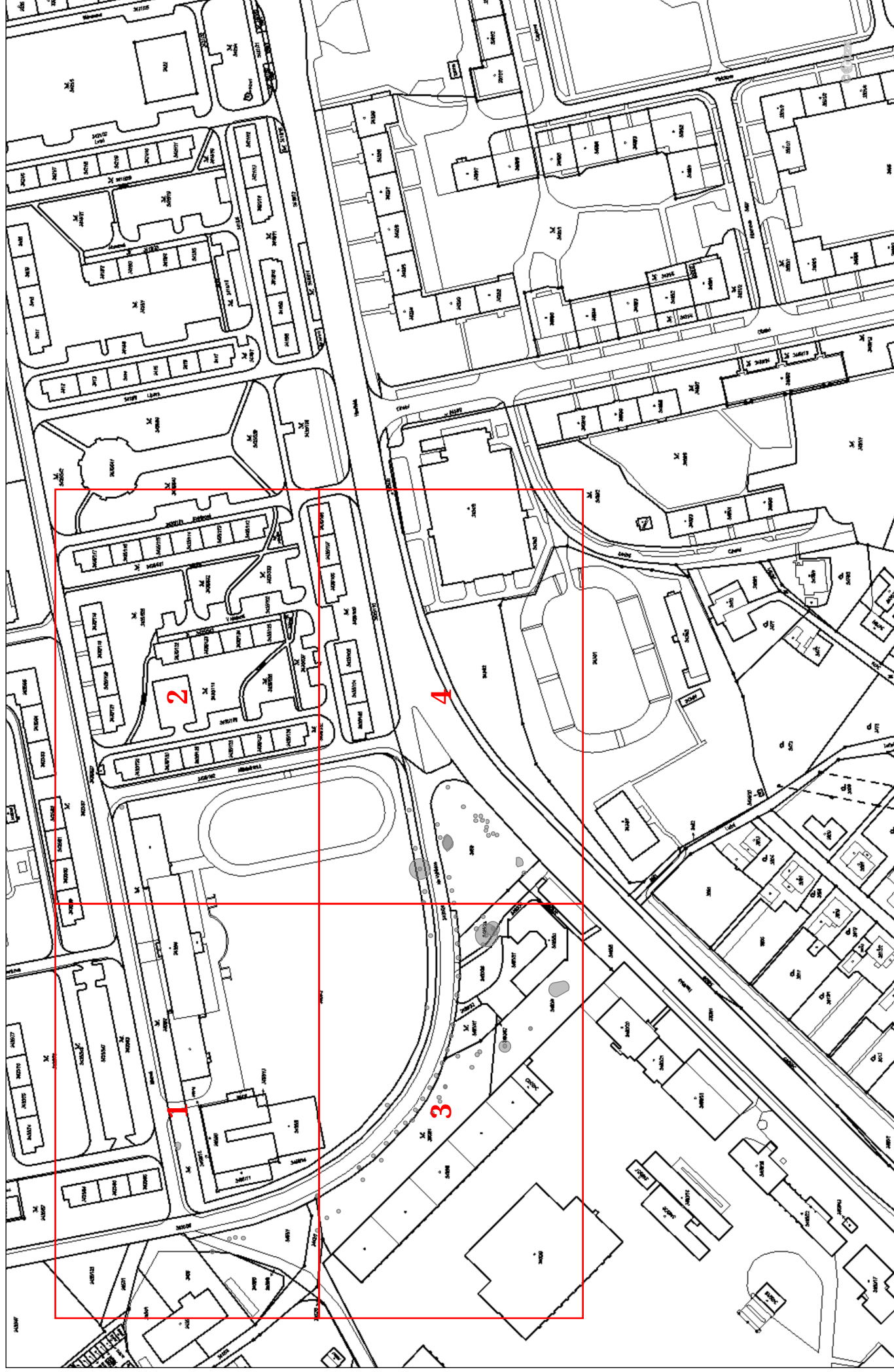



# Na Vyhliďce - okolo ZŠ(1:700), 1/4

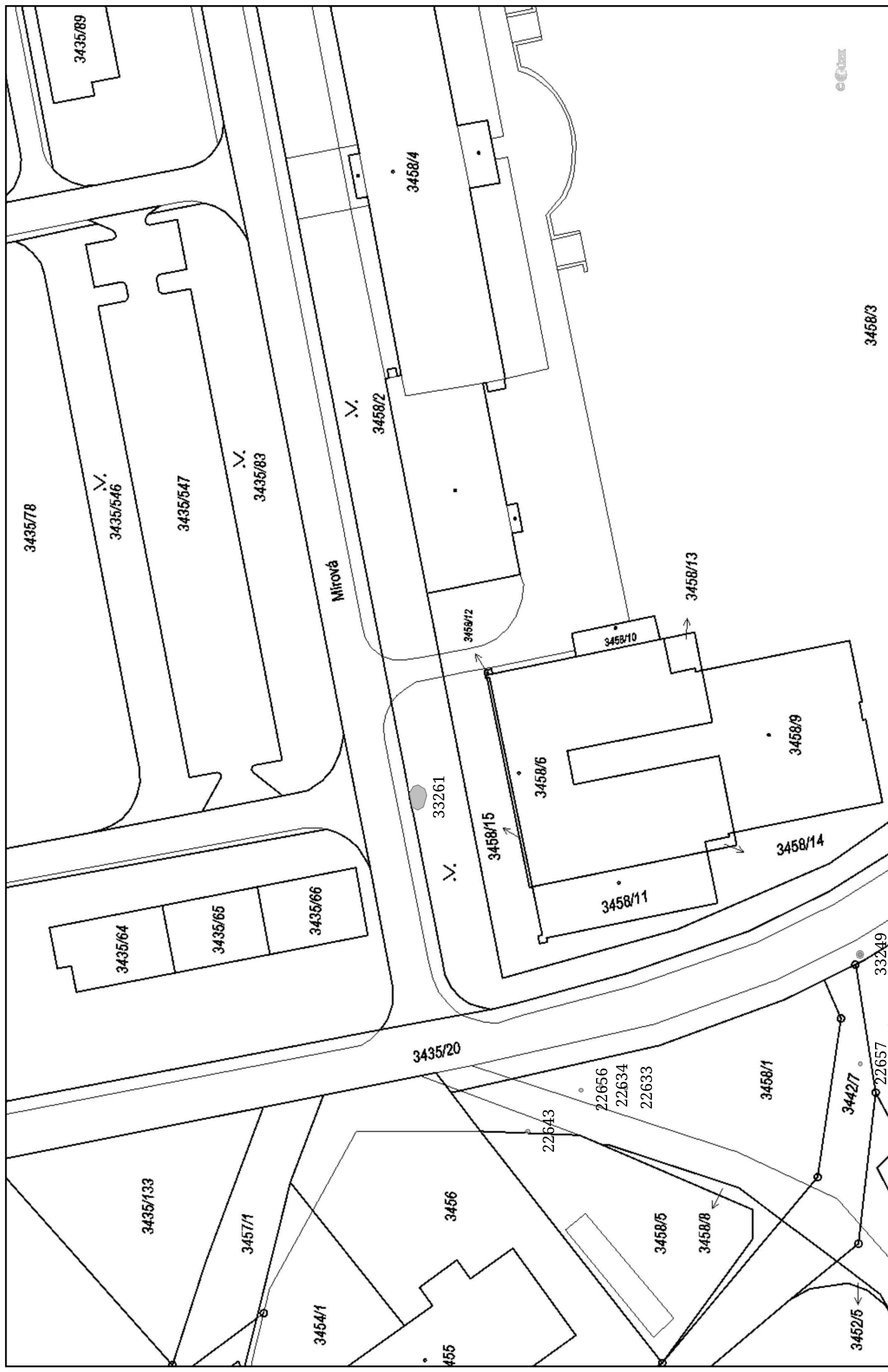

# Na Vyhliďce - okolo ZŠ(1:700), 2/4



# Na Vyhliďce - okolo ZŠ(1:700), 3/4

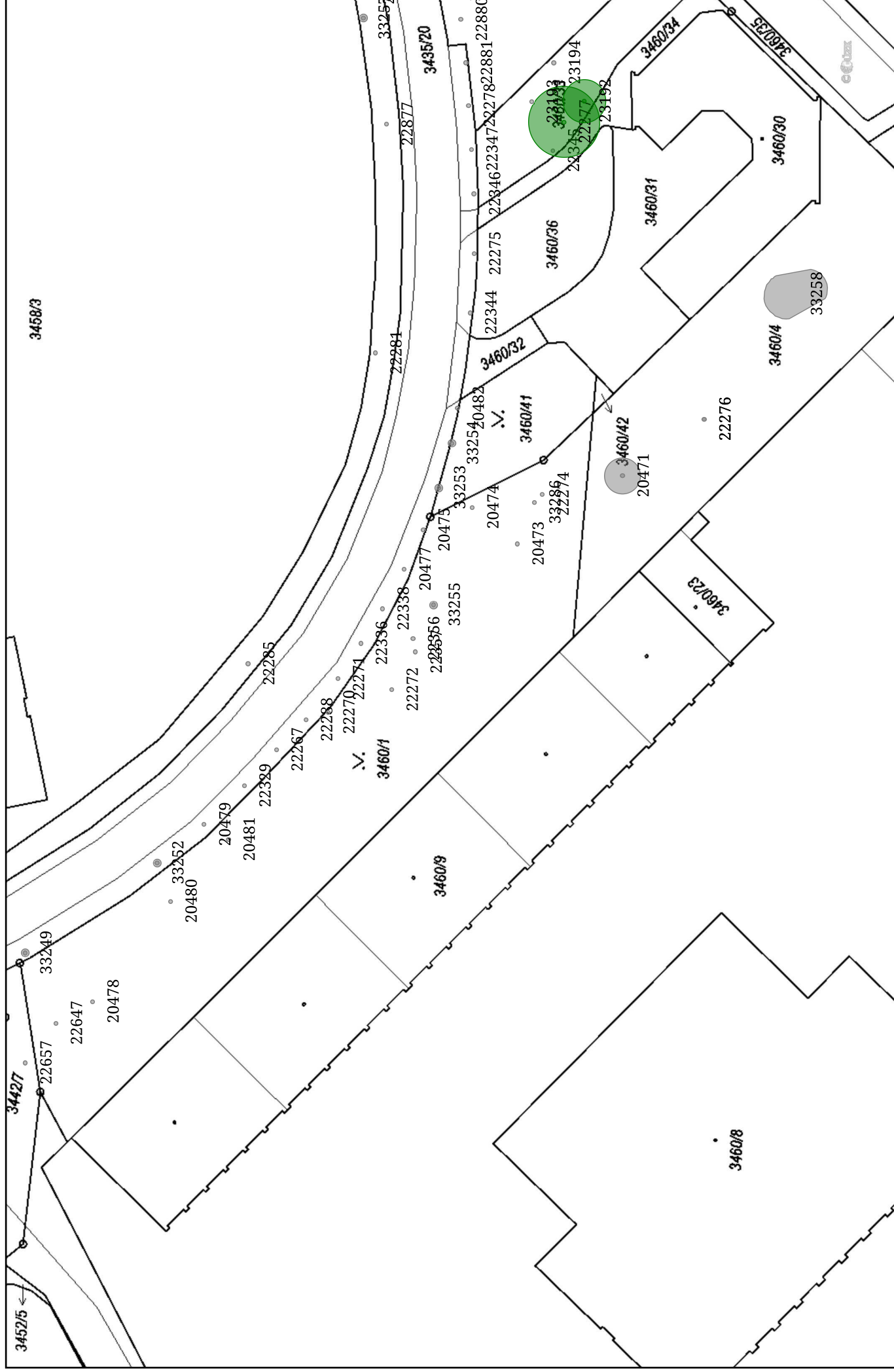

# Na Vyhlídce - okolo ZŠ(1:700), 4/4

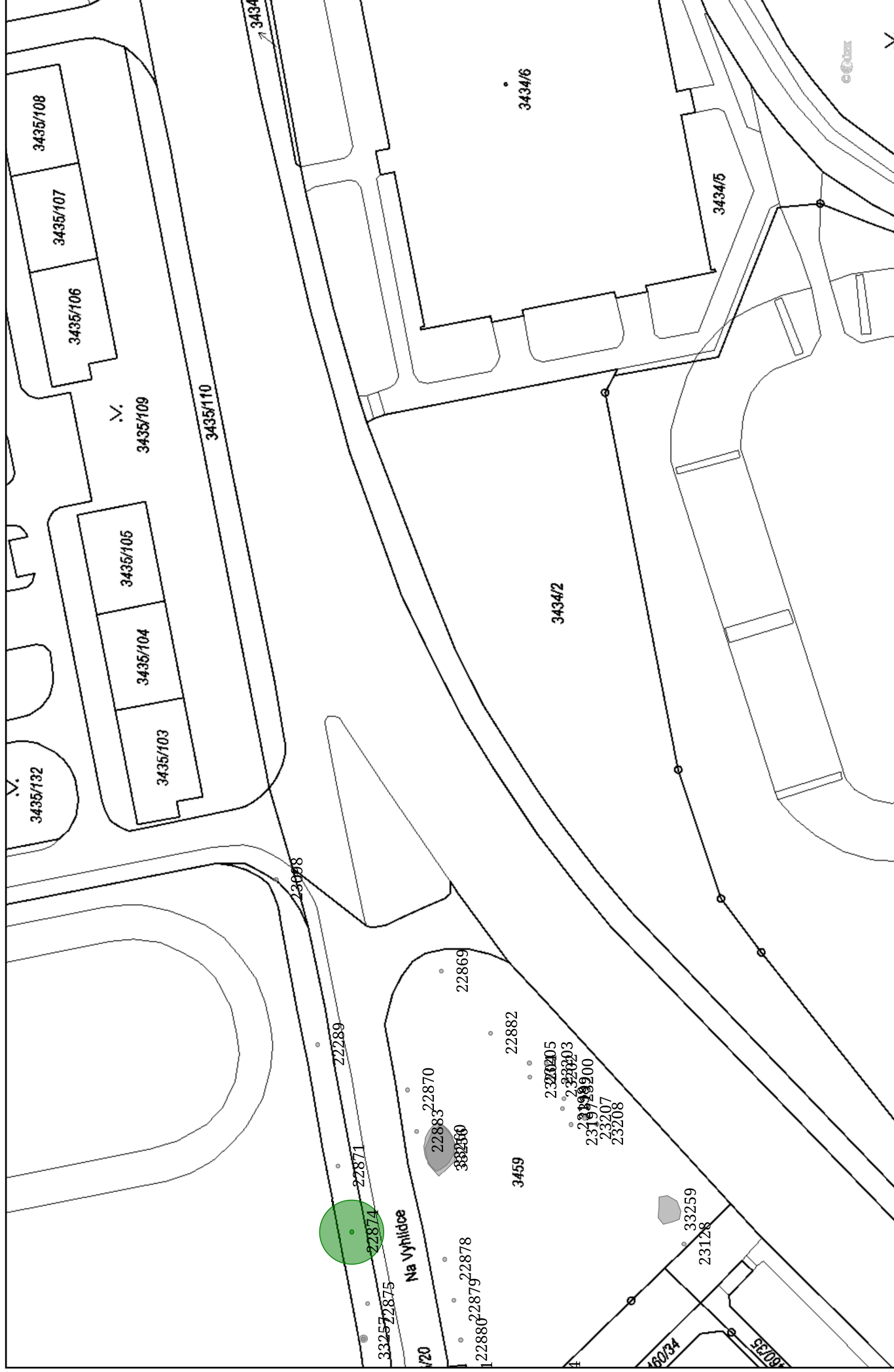



# Na Vyhlídce - parčík(1:700), 1/1

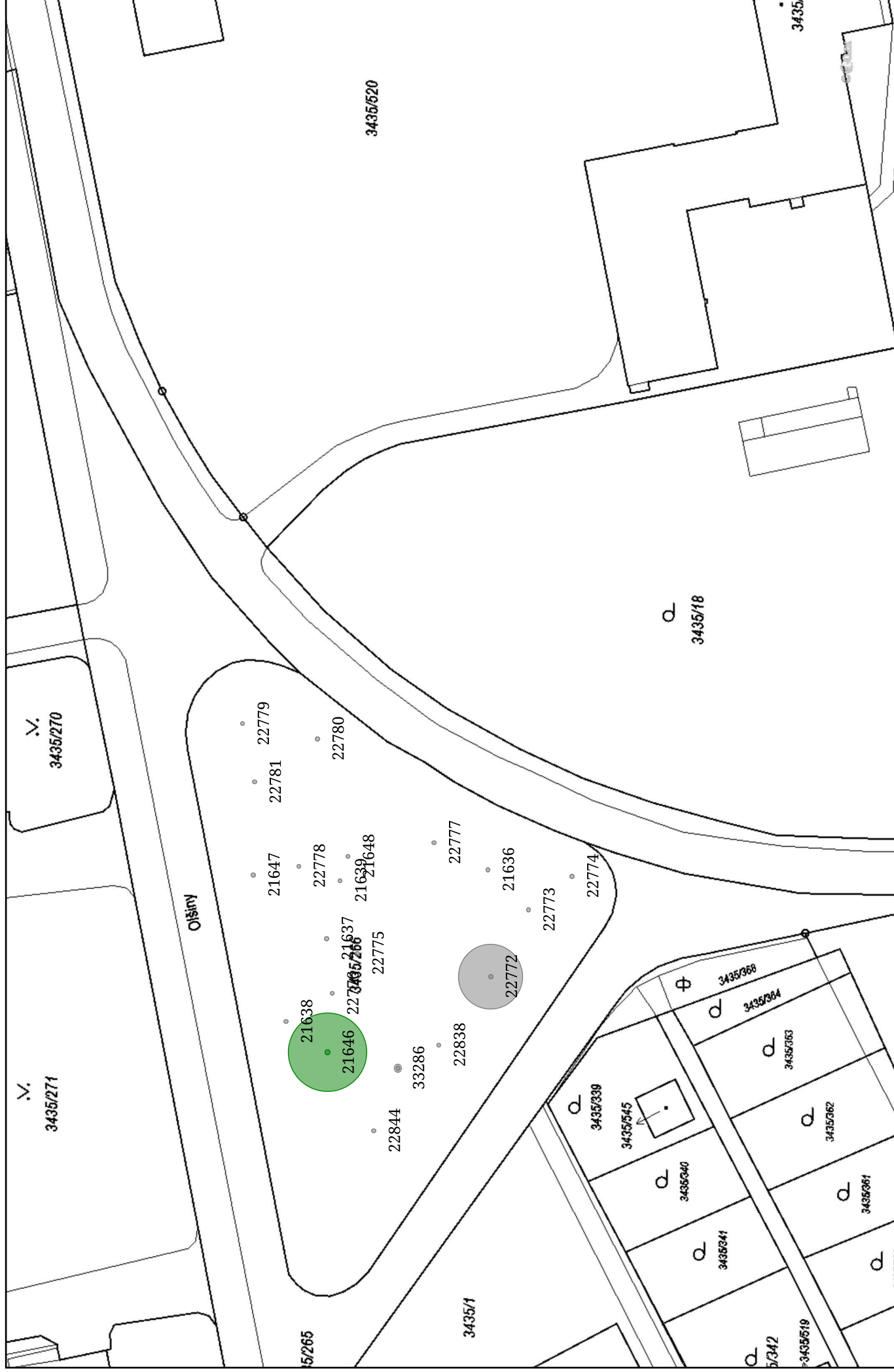

# Na Vyhlídce - před hřbitovem(1:700), 1/1



# Nerozdělené(1:700) - Klad listů (1:22312)

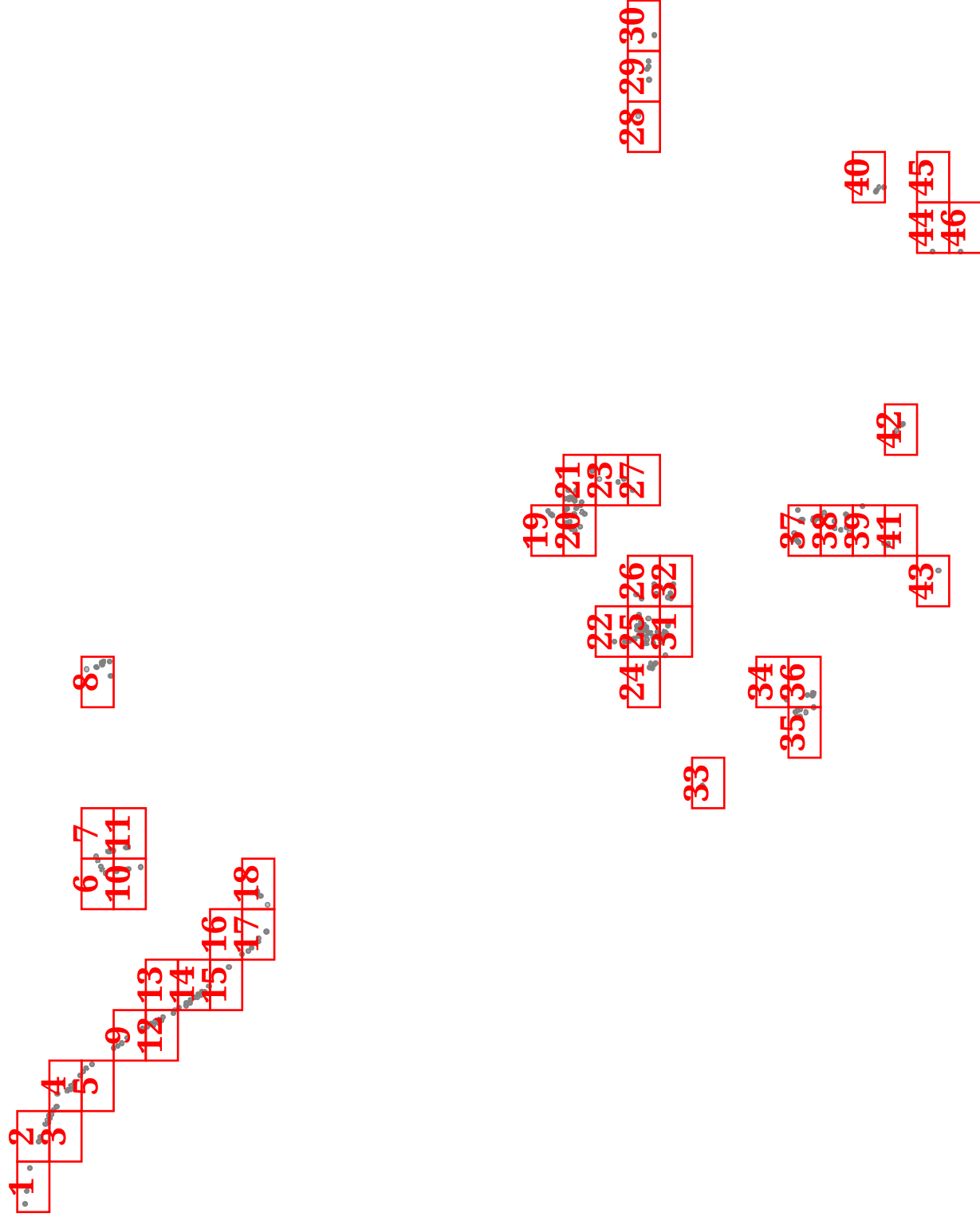

# Nerozdělené(1:700), 1/46

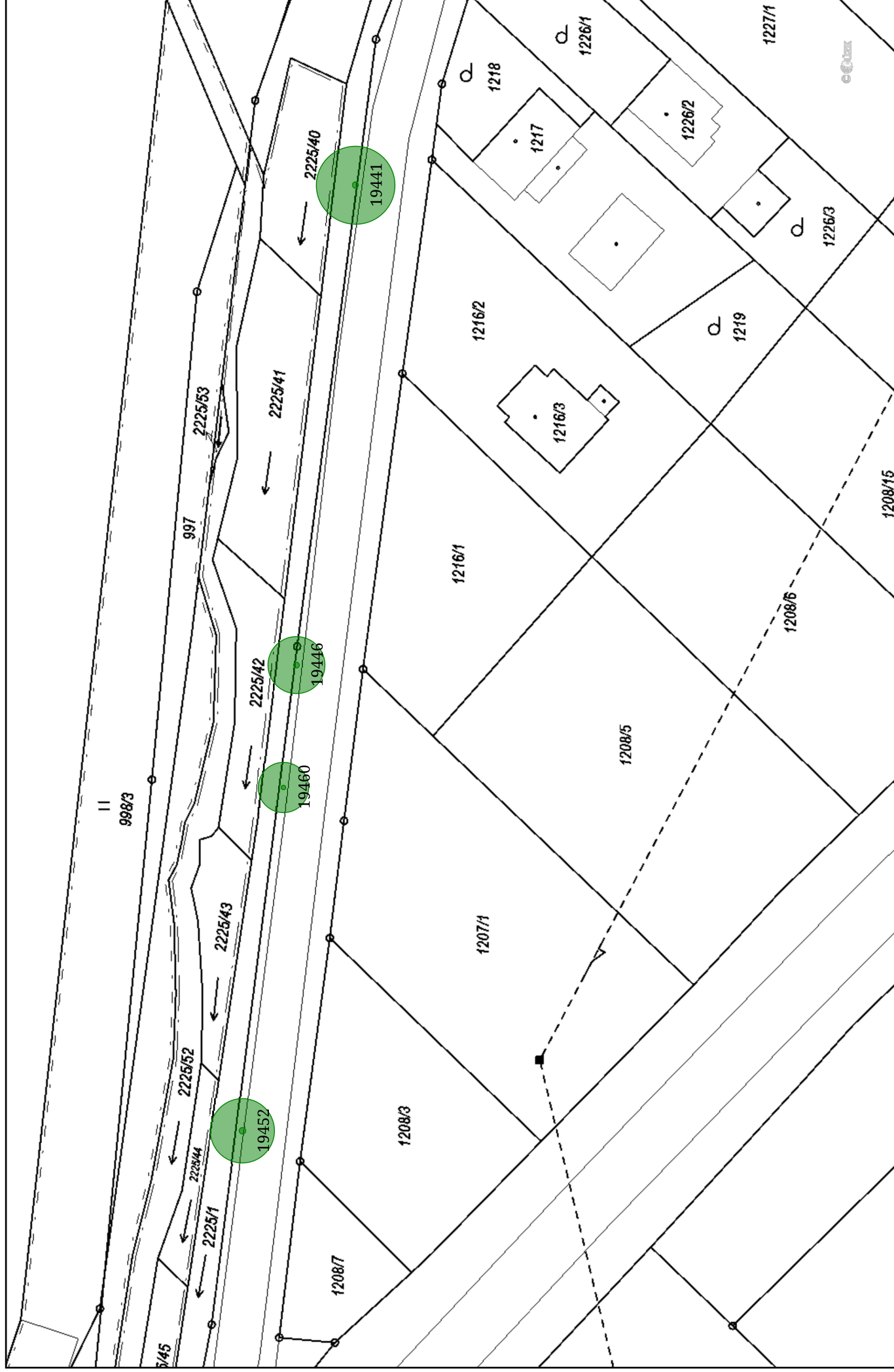

# Nerozdělené(1:700), 2/46





# Nerozdělené(1:700), 3/46

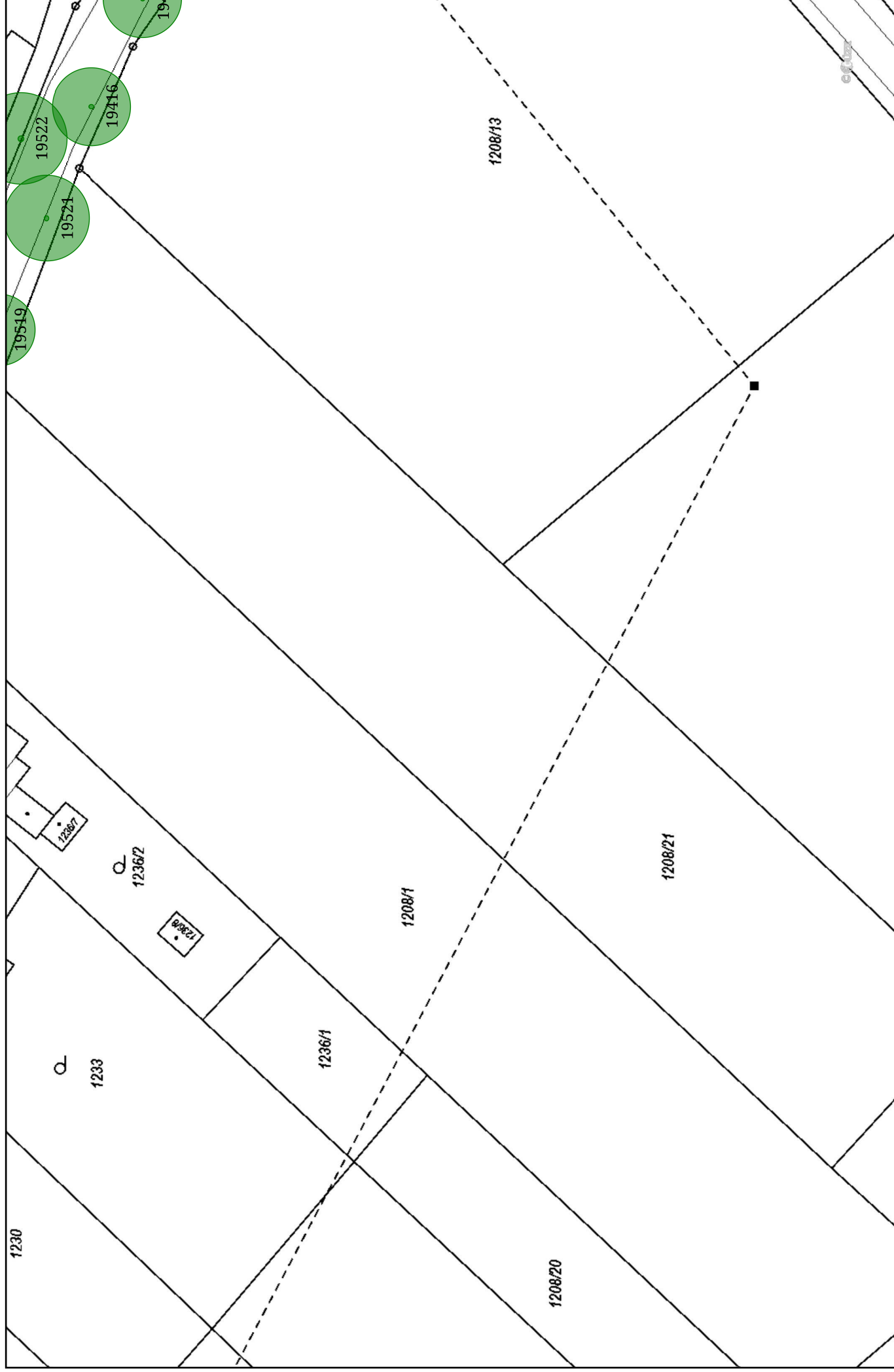

# Nerozdělené(1:700), 4/46

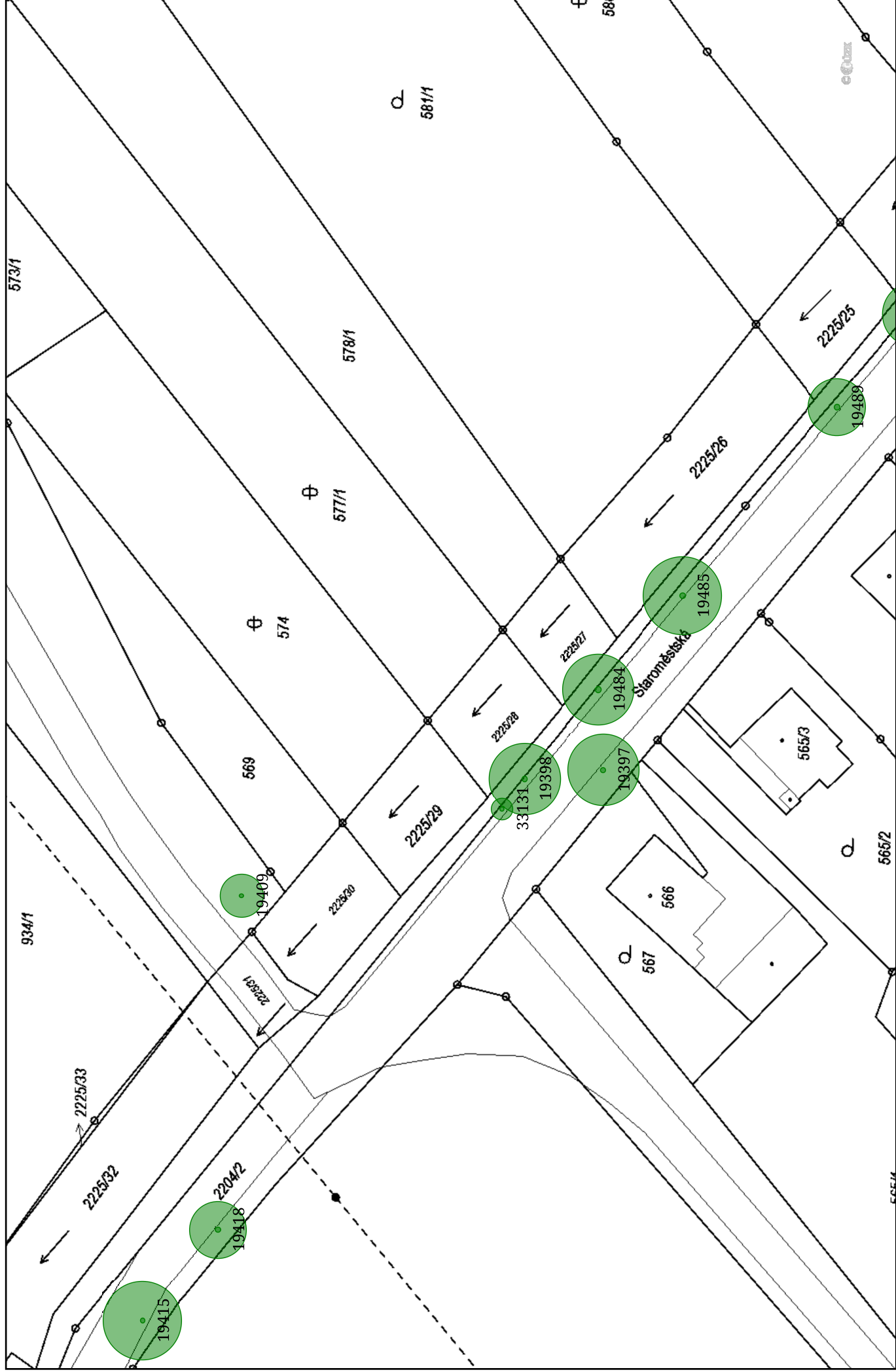

# Nerozdělené(1:700), 5/46

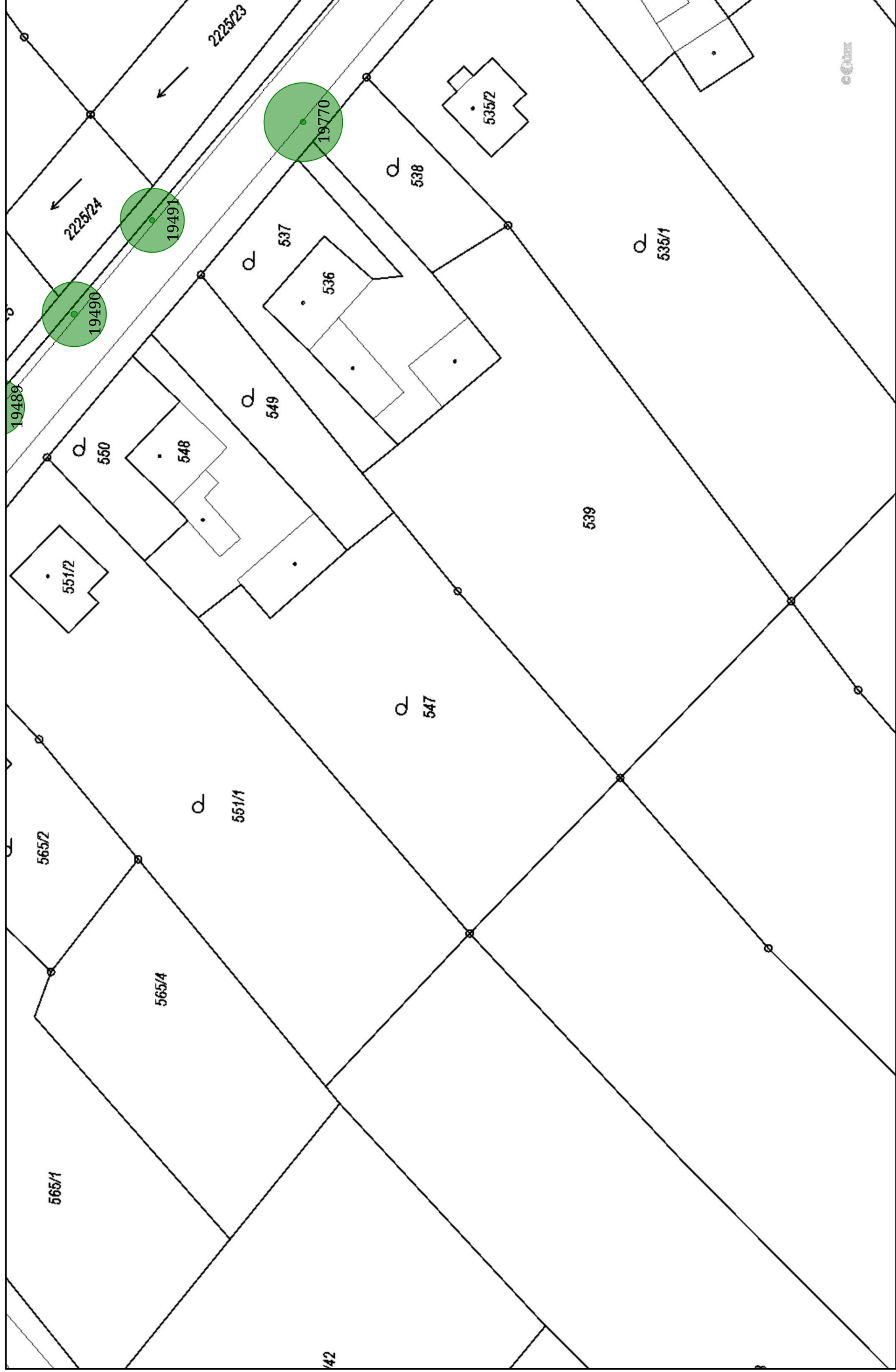

# Nerozdělené(1:700), 6/46



# Nerozdělené(1:700), 7/46





# Nerozdělené(1:700), 8/46

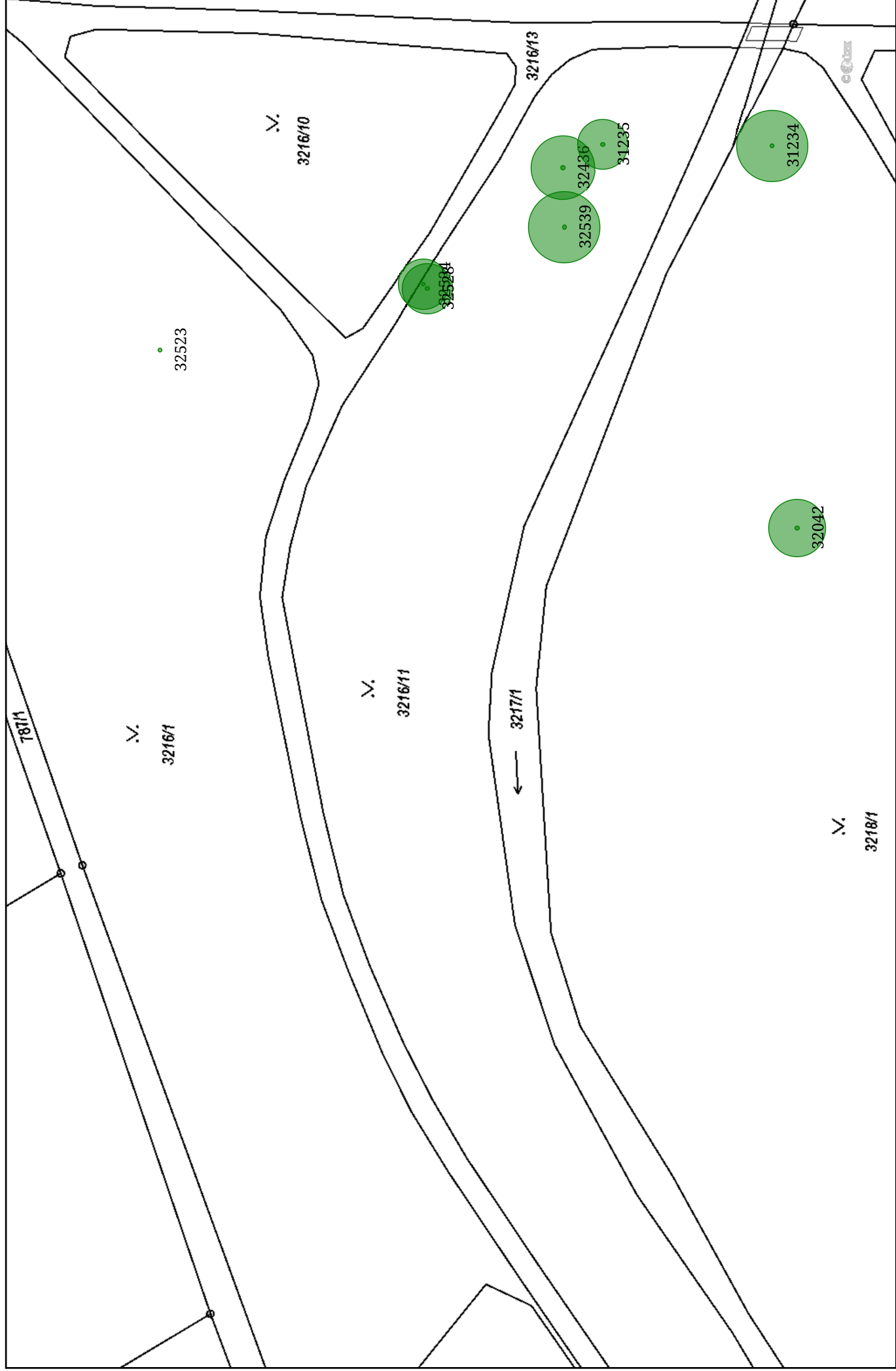

# Nerozdělené(1:700), 9/46

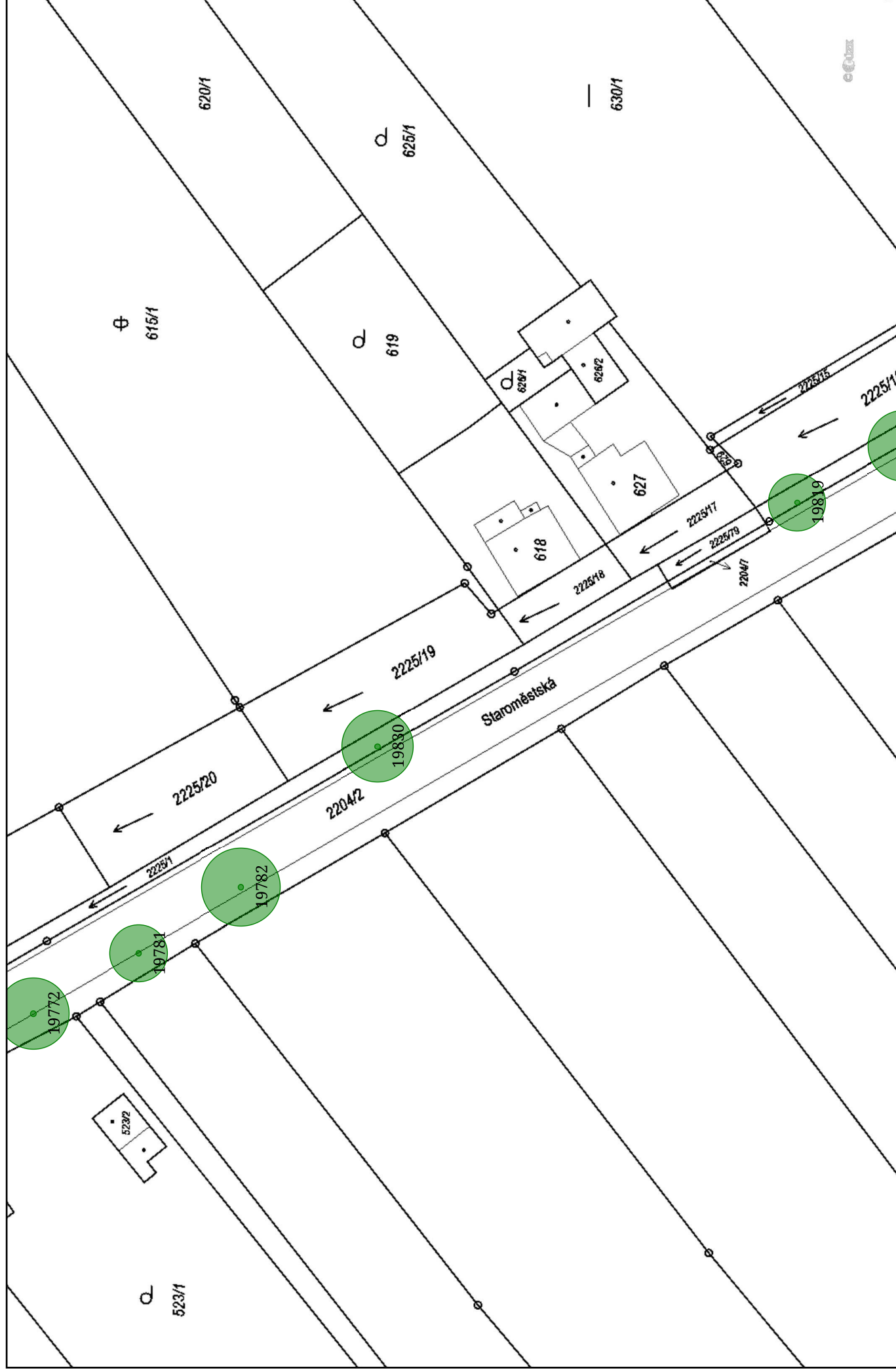

# Nerozdělené(1:700), 10/46

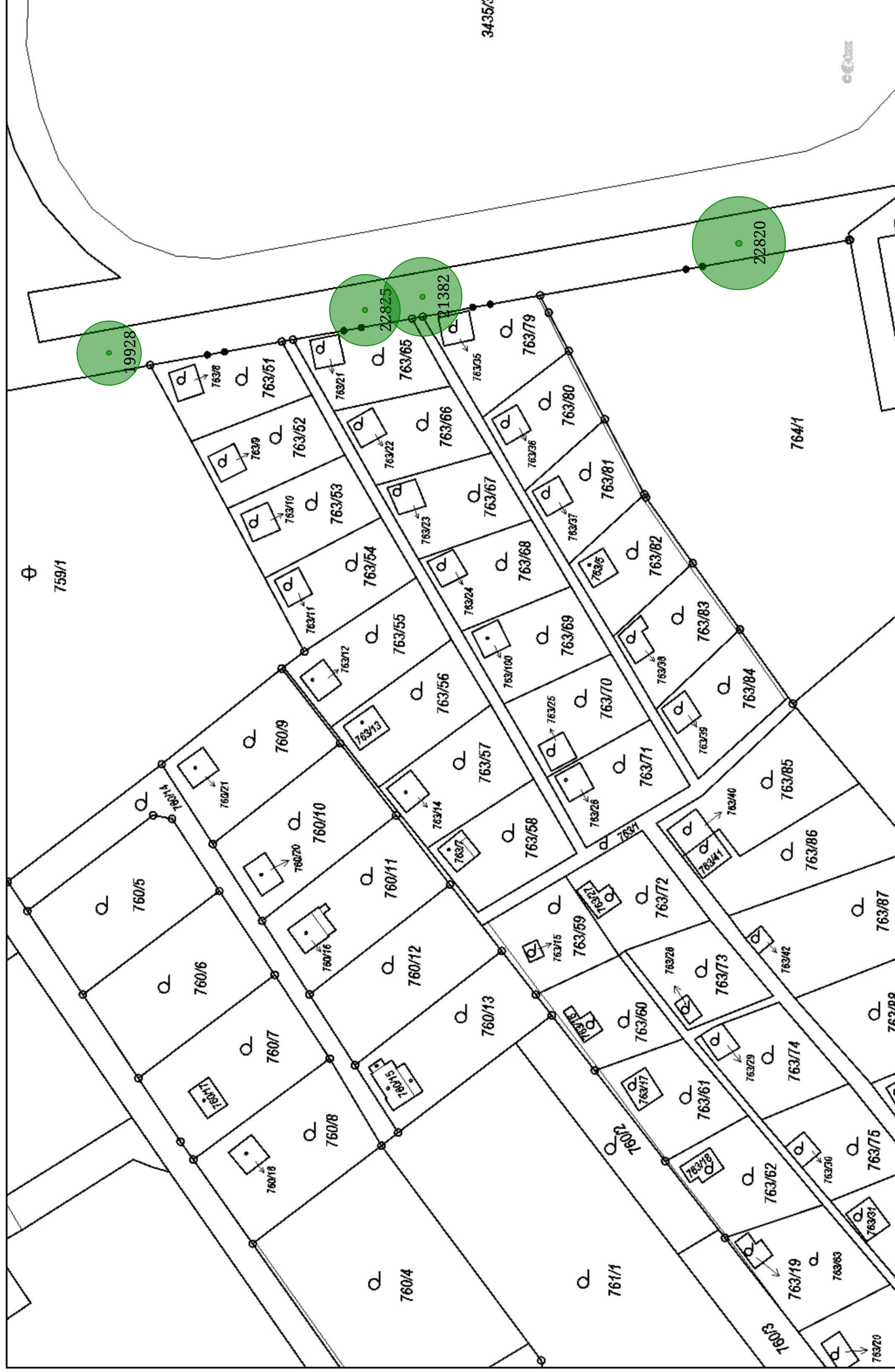

# Nerozdělené(1:700), 11/46

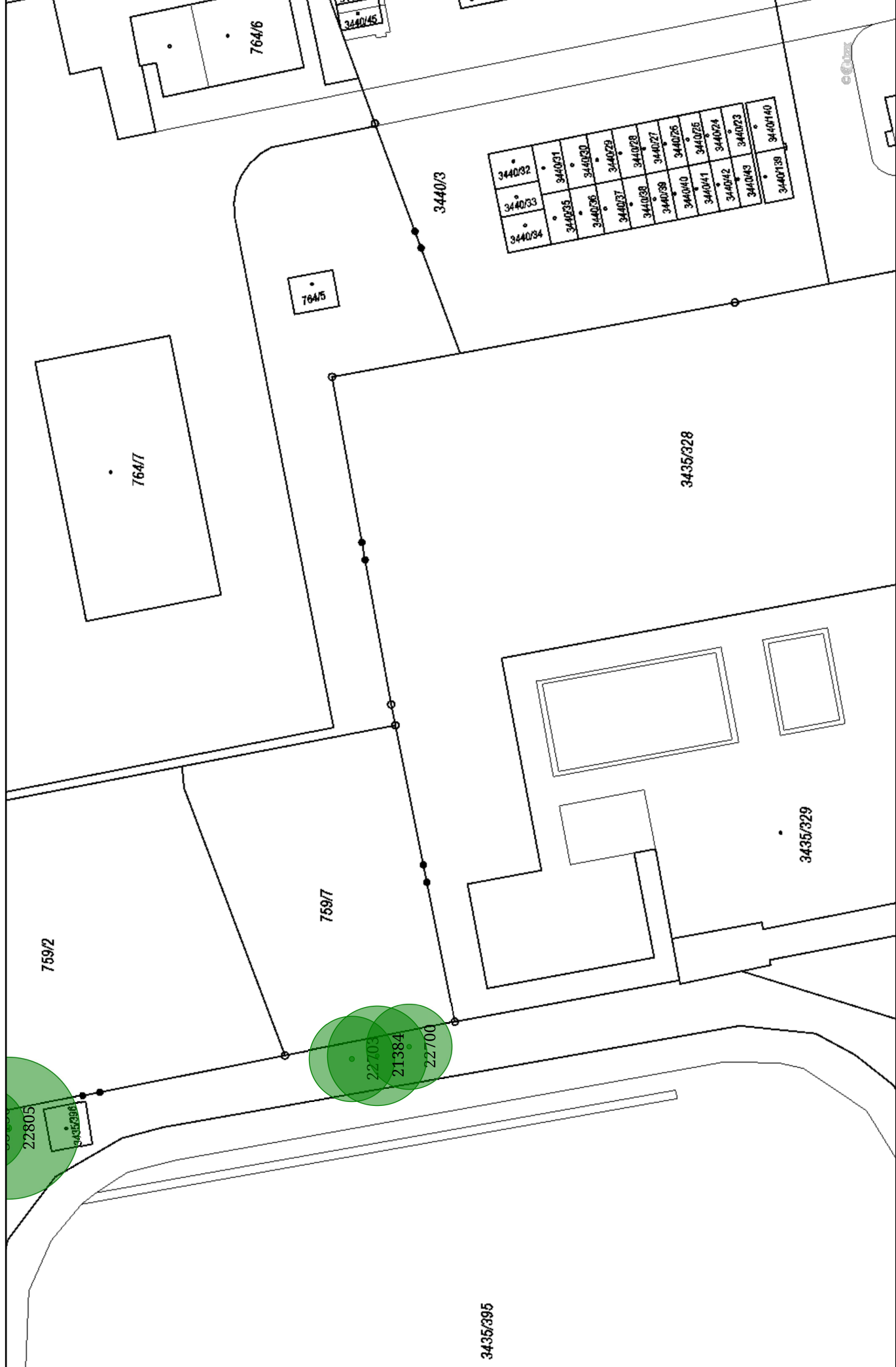

The image is a technical map or plan showing a road network. Several green circular markers are placed along a main road, each containing a number: 19820, 19822, 19823, 19824, 19825, 19826, 19827, 19806, and 19803. The road is labeled with various identifiers: 2225/16, 2225/14, 2225/13, 2225/12, 2225/11, 2225/10, 2225/78, 493/8, 493/7, 493/1, and 493/2. A street name 'Staroměstská' is also visible. Arrows indicate the direction of travel along the road. The map is oriented with the road running diagonally from the top-left towards the bottom-right.



# Nerozdělené(1:700), 13/46

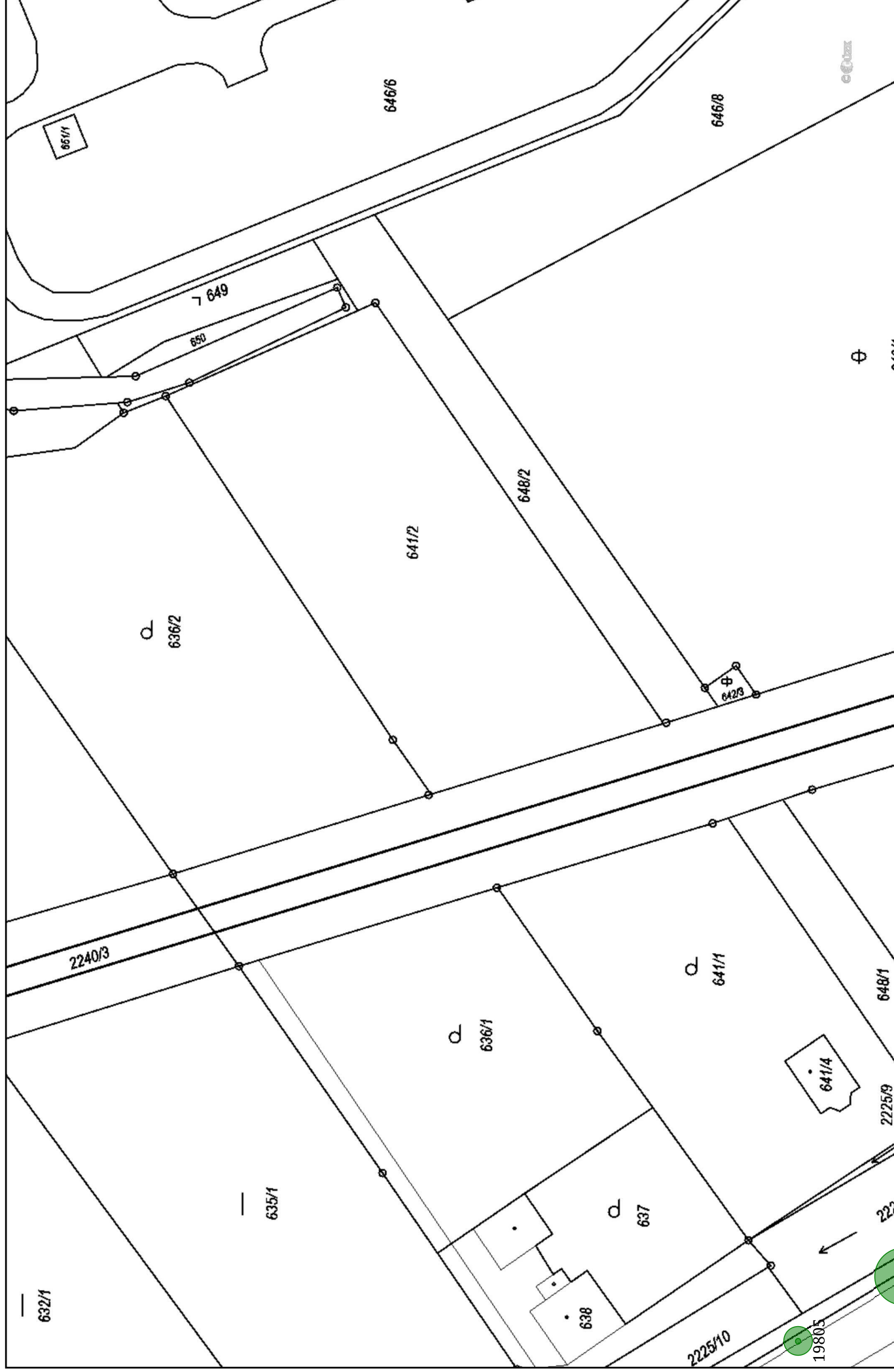

# Nerozdělené(1:700), 14/46

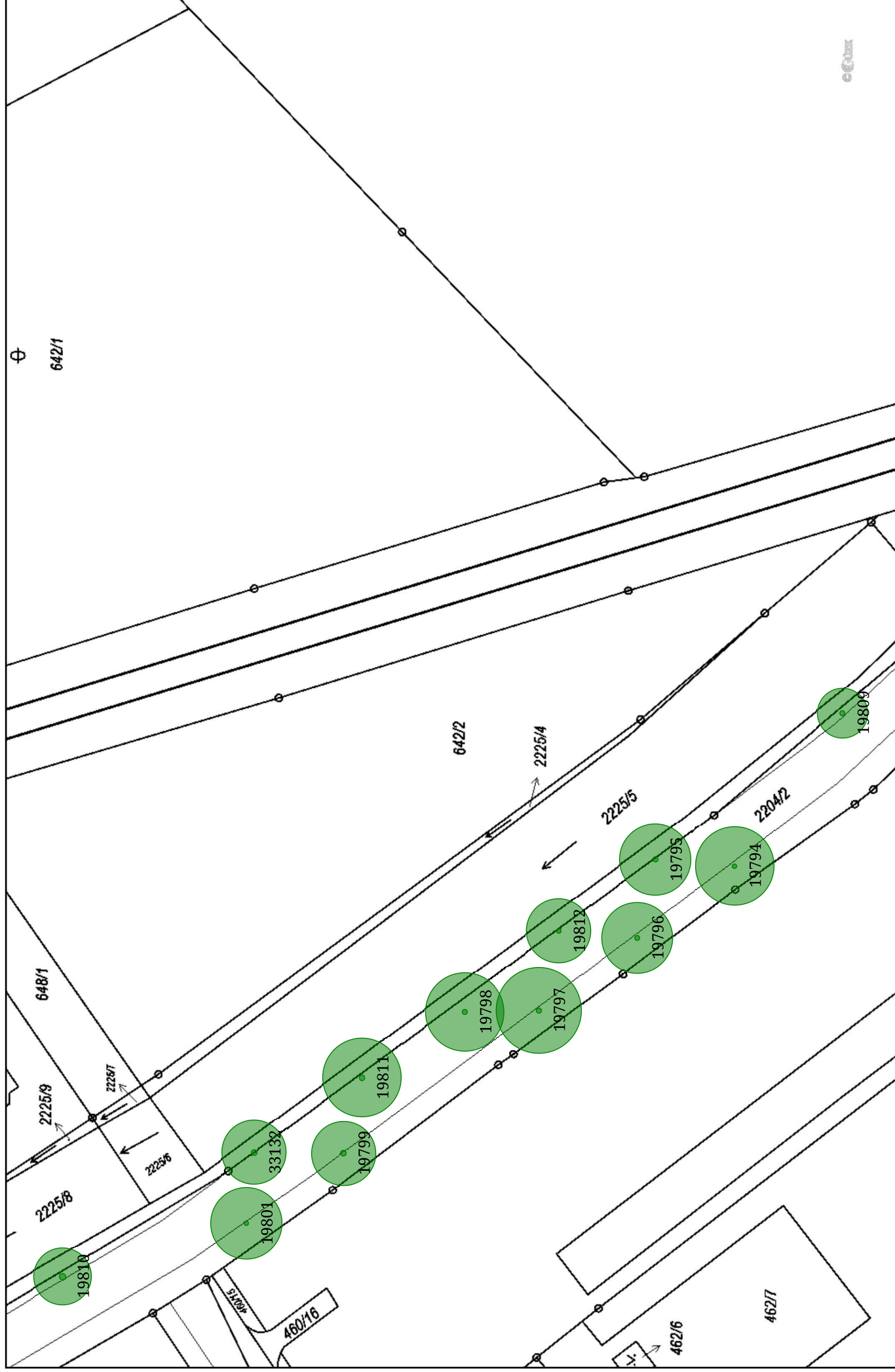

# Nerozdělené(1:700), 15/46

